



## Concentric-Arc Workstations

Americon manufactures many configurations of consoles. Among them are our straight consoles, cockpit style angular consoles and our concentric-arcs. The beauty of the concentric-arc is that they



need no transition pieces between them to create the shape of the configuration. This increases usable workspace and eliminates a lot of extra seams. We can even create concentric arcs consoles in our more complicated workstations like the one to the left which is a part of our Commander Series enclosed versions. The unique materials and processes we use in manufacturing allow us to supply products well outside the traditional bumper molding or laminate tapes used by others. This sets us apart from our competitors.

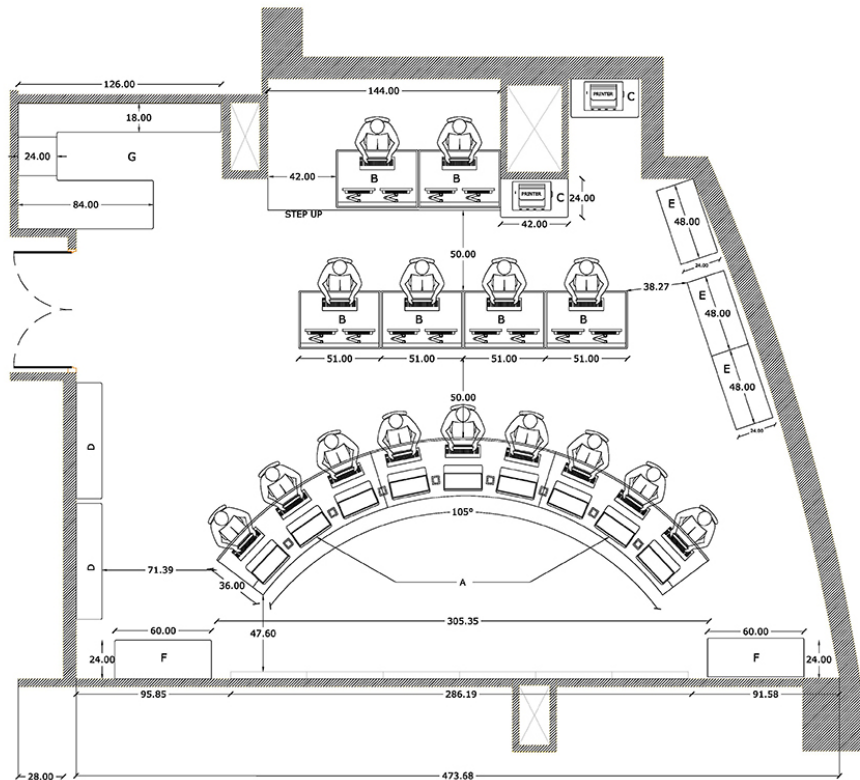

A good example of combining concentric and linear consoles



Charleston AFB Emergency Management Center

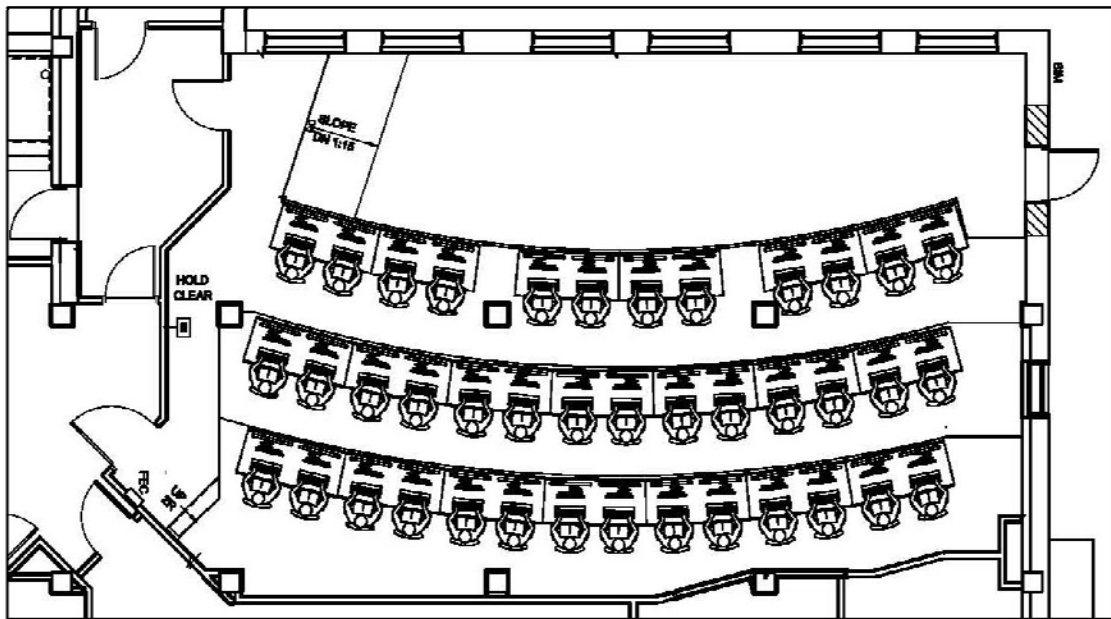

Fort Knox Emergency Management

When designing for an amphitheater environment, the secret to the concentric arc design is to maintain the same distance between each row. You also have to give each person the same amount of workspace which requires a basic understanding of geometry. If you continue the arc you will find that an arc is part of a circle. So the circle that is created for the first row in the example of Ft. Knox has a specific radius. Subsequent rows create arcs with larger radii. In the case of the configuration above, we maintain a consistent distance of 48" between the rows and each with a 72" wide workstation that is 36" deep. This configuration sets floor tiers at 84" apart which gives plenty of room to walk behind seated individuals and passes fire codes.