

# REQUEST FOR QUALIFICATIONS

Deadline: March 15, 2019

Rendering of Memorial Park  
(image by CARBO)



## CALL FOR ARTISTS: Memorial Park Public Art Opportunity

*Mural / Artistic Wall Treatment*

City of Siloam Springs, Arkansas



## BACKGROUND

**Siloam Springs** is a quaint and friendly town full of history in Northwest Arkansas with a growing appreciation and desire for public art. The heart of the town is its award-winning downtown, which exemplifies what makes Siloam Springs unique: a vibrant and diverse business community in a cherished natural and historic setting. Downtown Siloam Springs is adjacent to the much-anticipated Memorial Park (opening Spring 2019) which will promote wellness and the arts, with plenty of open green space, a splash pad, Farmers Market and demonstration kitchen, a new amphitheater, and several sites for future public artworks. Siloam Springs has a population of approximately 16,500, but it is home to the third busiest entryways into Arkansas and has a trade area population of over 62,000. Siloam Springs' acclaimed restaurants and shopping, charming historic district, and natural assets make it a desirable tourist location, and will gain increasing attention as the arts continue to develop and enrich the town.



ABOVE: Rendering of Memorial Park (image by CARBO)

BELOW: Retaining wall location in park.

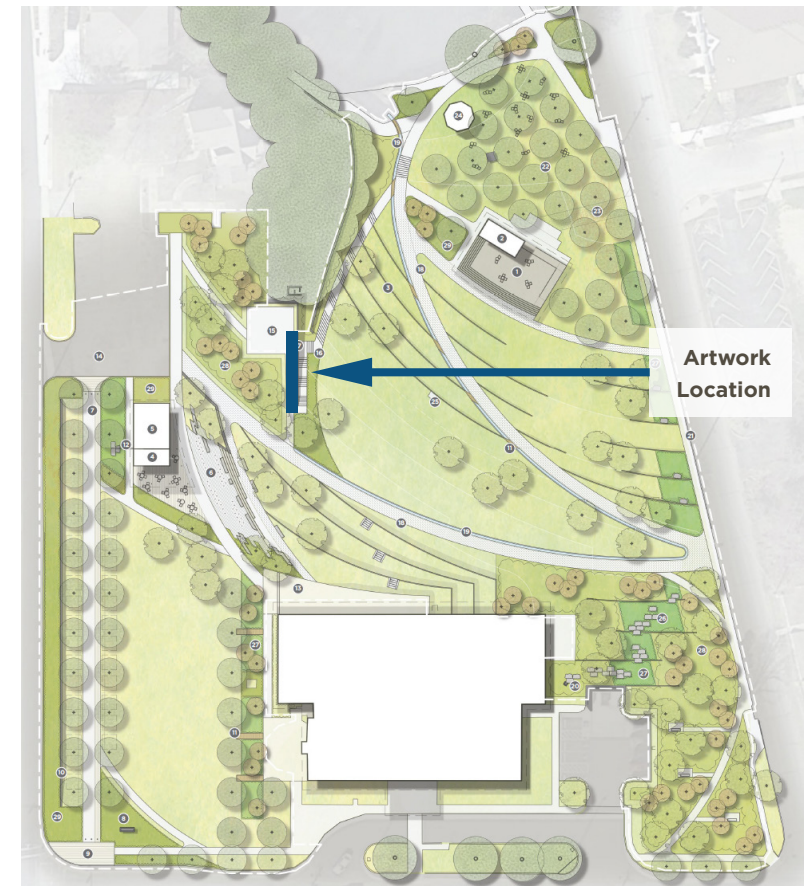

## THE NEW MEMORIAL PARK

Memorial Park, bordered by South Mt. Olive, West Jefferson, and South Maxwell Streets, will be Siloam Springs' newest and most engaging gathering place when it opens on Memorial Day, 2019. Historically this area was the location of the Chautauqua and later the memorial hospital, and is now home to the public library. The City is excited to continue using the site as a space in which the public can gather and use for their pleasure. The park is designed to remain open, flexible, and easy to maintain, with lawn and shade trees. Planting beds are strategically located at entrances, high visibility areas, and buffer areas. The "Arkansas native garden" areas at opposite corners of the site will help educate visitors on native plants and ecology. Rain gardens throughout the site will collect and filter stormwater to reduce pollution and provide an additional educational opportunity. The park, adjacent to the public library, is able to support a number of highly active programs and structures while maintaining a park-like character and providing organized green space for the entire Siloam Springs community.

## OVERVIEW OF PROJECT SCOPE

A priority site for art in Siloam Spring's new Memorial Park is the concrete retaining wall adjacent to the existing stairs along the west side of the park (see below). This highly visible, triangular concrete wall, at the base of the Veterans Memorial Plaza, offers an excellent opportunity to add a colorful story-telling element to the park and transform an otherwise drab concrete retaining wall into a meaningful focal point. The wall could accommodate a mural, mosaic, low relief, or some other type of artistic treatment. Please note that a substrate may be added to the wall to protect art from moisture seepage.

This project offers a special opportunity to help tell the story of the Siloam Springs community. The selected artist should consider involving local partners, such as the nearby library, tapping knowledge of local historians, researching images and information about the park site, or involving local residents from different generations and perspectives. The end result should generate civic pride in the project and the park.

Forecast Public Art, a nationally recognized nonprofit public art organization, is managing the RFQ and selection process on behalf of the city. We are hereby seeking applications from qualified artists or teams residing within 200 miles of Siloam Springs. The project budget is \$45,000, not including finalist design fees (\$750 per finalist, plus travel reimbursement).

### REQUEST FOR QUALIFICATIONS (RFQ)

Individual artists or teams are hereby invited to submit qualifications to be considered as finalists for this Memorial Park public art opportunity. Three finalists will be selected and paid stipends to develop proposals and present them to the Art Selection Committee at an in-person interview. One artist or team will subsequently be recommended to the City for commissioning.

BELOW LEFT: Detail of retaining wall in Memorial Park.

BELOW RIGHT: Overall dimensions of wall (approx. 70 feet long).

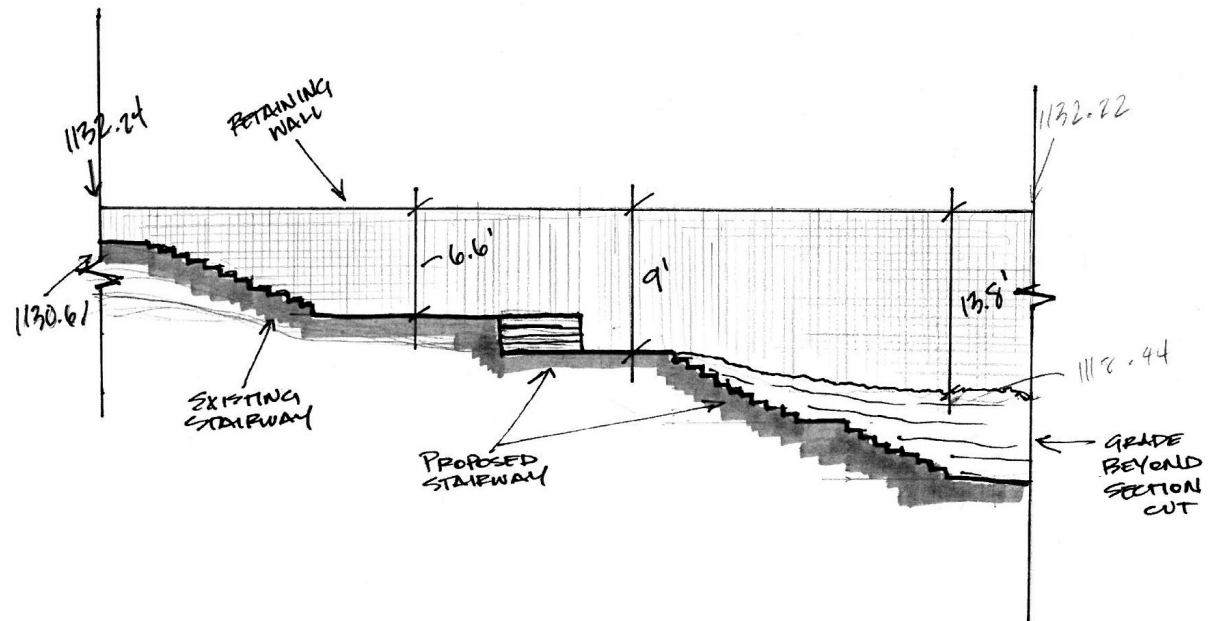



## BUDGET

**\$45,000**, including all fees, materials, fabrication, installation, transportation, etc. The budget must also provide for any additional substrate added to the surface of the wall as a protective measure against moisture seepage. Note: the budget does not include lighting, however there is power at the site.

## SELECTION CRITERIA

In addition to meeting eligibility requirements (listed below), selection of finalists will be based on the following criteria:

- Quality of letter and quality of work samples
- Ability of artist or team to successfully design, produce and install project, based on application materials provided.

For finalists, design concepts must meet the following criteria:

- Conveys artistic excellence and supports goals of the project and the Park
- Considers ways to creatively and meaningfully engage community (during design phase and/or as part of interactive engagement with audiences)
- Has a broad appeal, and considers the diverse audiences visiting the Park
- Is durable, relative to the environment, vandalism, and changing seasons
- Is considered safe and low-maintenance

## ELIGIBILITY

- Applicant must be an experienced visual artist, or a team led by an experienced artist
- Applicant must be 18 years of age or older and reside within 200 miles of Siloam Springs, Arkansas
- Applicant must provide evidence of producing a large-scale outdoor wall project within the past ten years
- City of Siloam Springs staff, Forecast Public Art staff and Art Selection Committee members are ineligible

## SCHEDULE

<b>February 20, 2019</b>	RFQ announced
<b>March 15</b>	<b><i>Deadline for RFQ submission</i></b> ; all required materials must be received by <b>4 p.m. CST</b> (a confirmation email will be sent to applicants once materials are received)
<b>March 20</b> (tentative)	Committee review and selection of finalists
<b>March 25</b>	Contract with finalists for design phase
<b>March 26</b>	Finalist site visit / meeting with City representative
<b>April 29</b> (tentative)	<b><i>Interview with Art Selection Committee</i></b>
<b>May 12</b>	Announcement of selected artist
<b>May 25</b>	Presentation of preliminary design at Park Dedication event
<b>July 2019</b>	Design development phase completed
<b>October 2019</b>	Project completion

## SELECTION PROCESS OVERVIEW

The Art Selection Committee, established by the City of Siloam Springs, will review applications and select three artists or teams as finalists to create design concepts for the site. Finalists will be paid a modest stipend have approximately seven weeks to develop design concepts (including an initial site visit and meeting with key stakeholders). Finalist will present their concepts in an in-person interview, and one artist or team will be selected to implement their project, contingent on approval of the committee's recommendation by the City of Siloam Springs and acceptance of subsequent design development deliverables.

## REQUIRED SUBMISSION MATERIALS

**DIGITAL FORMAT ONLY** — Please provide the following in 12-point font, in ONE PDF DOCUMENT:

- Contact information for lead artist and each team member
- Three references (contact information only) for recently completed projects
- One-page letter describing interest in project and approach to design; please include statement addressing eligibility criteria
- One-page listing of each work sample; please provide a brief description and budget for each work sample. Please indicate which team member(s) played a role in the project, and describe the role
- One-page biographical information or resume for each team member
- Work samples list (see right for instructions)

## WORK SAMPLES

Please provide up to 10 separate digital images of your recent and relevant projects; each image file should not exceed 1 MB. Applicants are limited to 10 images maximum (please don't include multiple images in one file). Save all images as standard JPEG and label each with applicant's full name and number in sequence corresponding with the list of work samples.

### HOW DO I APPLY?

Submit all RFQ materials via email to: [Consulting@ForecastPublicArt.org](mailto:Consulting@ForecastPublicArt.org)  
All materials must be received by **4 p.m. on Thursday, March 15, 2019.**  
No RFQs will be accepted after this time.

Email project manager Jack Becker at Forecast Public Art with any questions: [Jack@ForecastPublicArt.org](mailto:Jack@ForecastPublicArt.org)

Forecast is committed to a policy of providing opportunities to people regardless of economic or social status and will not discriminate on the basis of race, color, ethnic origin, national origin, creed, religion, political belief, sex, sexual orientation, marital status, age, veteran status, or physical ability.



P.O. Box 80  
Siloam Springs, AR 72761  
Phone: 479-524-5779

[siloamsprings.com](http://siloamsprings.com)

**FORECAST**  
PUBLIC ART | PLACEMAKING | DESIGN