

608/950M

Deep Groove Ball Bearings (single row, metric)

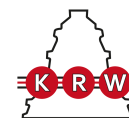

Details:

Main dimensions

d [mm]	950	d ₁ [mm]	≈ 1021. 5
D [mm]	1150	D ₁ [mm]	≈ 1079. 5
B [mm]	63	r _{1,2} [mm]	5
Weight [kg]	≈ 144		

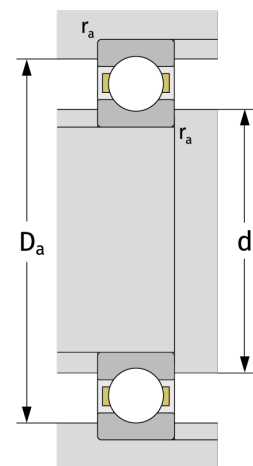
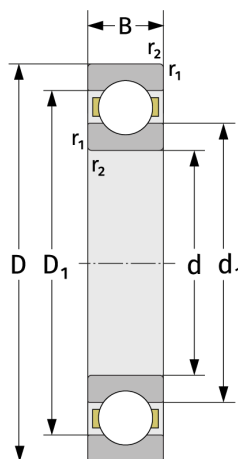

Connection dimensions

d _{a, min} [mm]	968
D _{a, max} [mm]	1132
r _{a, max} [mm]	4

Calculation data

C [kN]	525
C ₀ [kN]	1290
C _u [kN]	19.3
n _{th} [mm]	456
n _g [mm]	660
f ₀	15,6