

One of the **isomass**
systems range

isocheck™

Re-Mat M20

Wall System

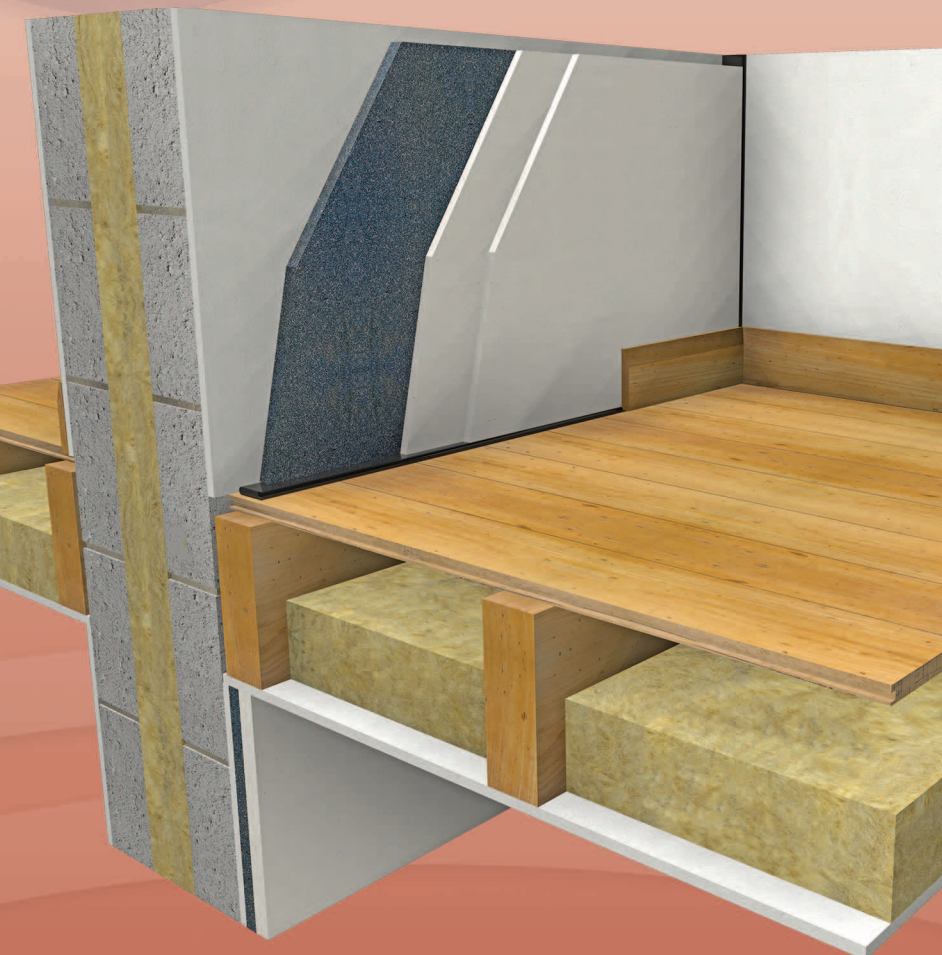

Recyclable
post-use

AIRBORNE IMPROVEMENT SYSTEM FOR WALLS

- Refurbishments
- Conversions



Taking the *mystery* out of Acoustics

DESCRIPTION

- ❑ Isocheck Re-Mat M20 system is designed to reduce airborne sound transmission through all types of existing domestic party walls with a minimal loss of room space.
- ❑ Isocheck Re-Mat M20 consists of a 20mm layer of matting constructed from 97% recycled rubber (tyres).
- ❑ Isocheck Re-Mat M20 will dampen and absorb the sound energy with its mass and rough composition.
- ❑ Re-Mat M20 is ideal for use to upgrade an existing separating and partition walls that is found to perform poorly for airborne sound transmission.

APPLICATIONS

- ❑ Re-Mat M20 is suitable for improving the sound insulation of walls, separating stairs and hallways - especially in situations where a minimal loss of space is essential.
- ❑ Re-Mat M20 could also be useful in some situations (and with the guidance of our technical team) to enhance a wall sufficient to comply with Part E of the building regulations.

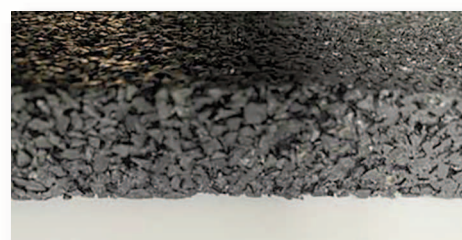

isocheck™
acoustic insulating products

Product data

Overall sheet size:	1.0m x 1.0m
Thickness:	20mm
Coverage per sheet:	1.0m ²
Colour:	Black
Flammability:	<100 mm/min (FMVSS 302)

Typical performance expectations

(On the party wall as illustrated below)

Treated wall with: Isocheck Re-Mat M20	Airborne sound insulation	$D_{nT,w} + C_{tr}$ 49dB
---	------------------------------	------------------------------------



Design guidance

Isocheck Re-Mat M20 is designed to modify or reduce airborne noise (such as audio, TV, talking, etc.). The effectiveness of the sound reduction will be improved in part by the dampening the path of flanking noise transmission that travels within the wall.

Our design team can prepare free design details unique to your situation to ensure the best achievable outcome.

Every effort has been taken in the preparation of this sheet to ensure the accuracy of representations contained herein. Recommendations as to the use of materials, construction details and methods of installation are given in good faith and relate to typical situations. However, every site has different characteristics and reliance should not be placed upon the foregoing recommendations. Advice can be given as to specific applications of the products, upon request to isomass building products.

SPECIFICATION

The acoustic wall shall be:

- Isocheck Re-Mat M20, supplied by Isomass Ltd. Units 10 & 11, Avenue Business Park, Off Brockley Road, Elsworth, Cambridgeshire, CB23 4EY and installed in accordance with manufacturer's instructions / recommendations.

INSTALLATION

- Remove any wallpaper and flaking paint from the wall and ensure the surface is sound, flat, clean and dry. Skim if required.
- Adhere Re-Mat M20 directly to the wall allowing a small gap at the top and bottom of the wall. Fill these gaps with flexible mastic sealant or Isocheck Isolation Strip. Additional mechanical fixings (approx 9 per sheet) can be used for added support if wall fittings are required.
- Adhere two layers of 12.5mm plasterboard to the Re-Mat M20. Finish with a plaster skim. Skirtings and fittings should be attached with plasterboard screws which do not penetrate the M20. Heavy items should not be hung off this system.

For advice on treatment of services and penetrations, consult our brochure or visit our website.