

# What Is This????

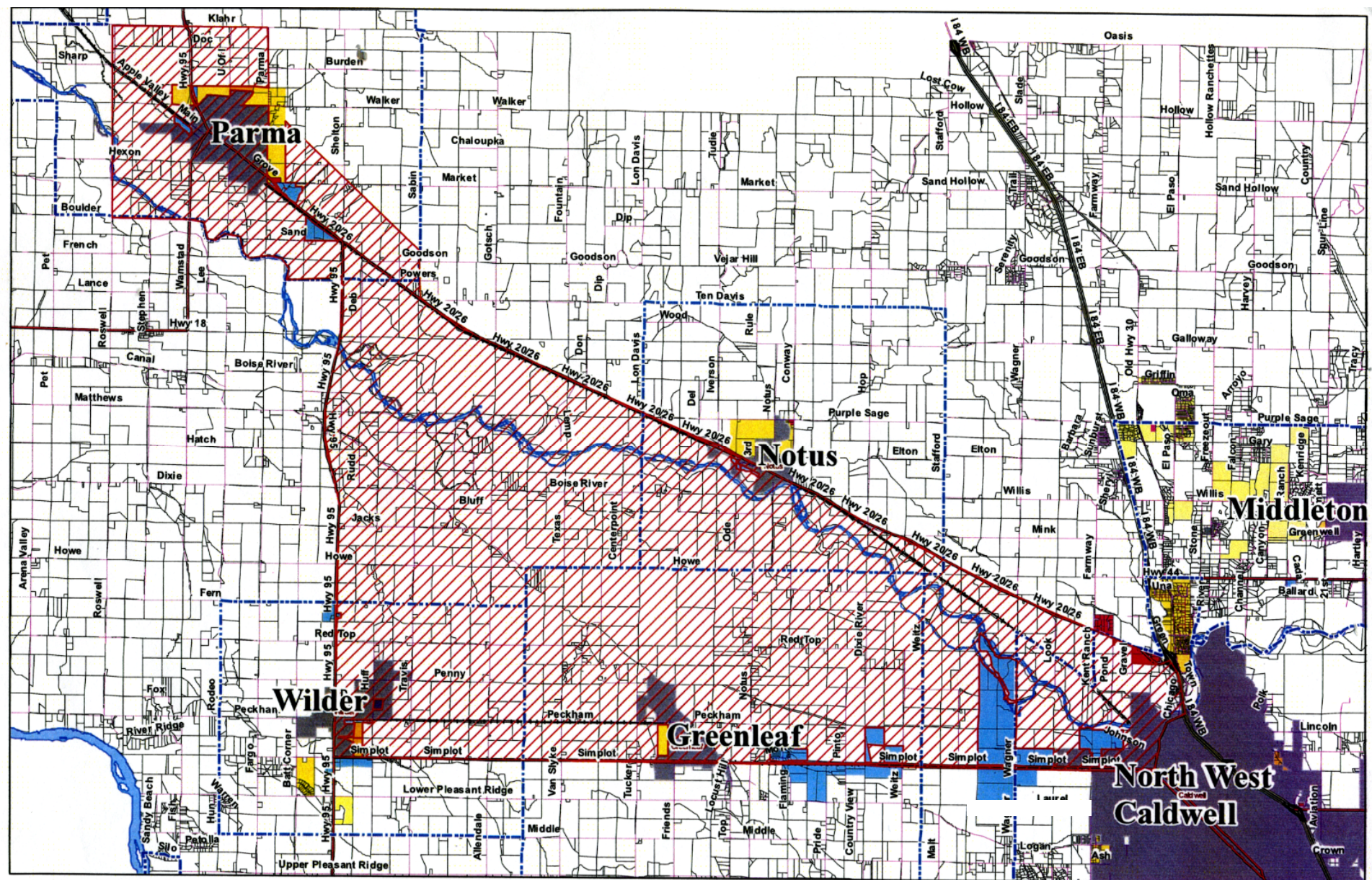

If you don't know what it is, then you need to. Canyon County is now in the process of revising the County's comprehensive plan and rewriting its planning and zoning ordinances. One new element is the creation of an Enterprise Zone, designed to stimulate job creation by providing federal and state incentives for new development. The striped area in red shows the land areas that are being proposed as the new Enterprise Zone. Commercial and industrial development would be encouraged in the zone.

The Coalition for Agriculture's Future is a strong proponent of new job creation. In fact, during 2009 our members added lots of new agriculture-related jobs putting people to work. But look at the proposed zone a bit more closely. It encompasses roughly 35 square miles of superb Canyon County agriculture land. We believe that poses a terrible risk to the future well being of our area's agricultural economy, and by that to Canyon County's economic outlook. Remember: Every acre of farmland lost to development costs Canyon County's economy almost \$9,000 per year.

Credible growth planning experts say development needs to migrate outwards from established municipalities. We absolutely agree. The Enterprise Zone currently being developed will do exactly the opposite. Do you really think developers would do the right thing and ignore more than 22,000+ acres of flat, level farmland?

Canyon County also wants to do away with the Conditional Use Permit provision that has allowed a flood of spot residential development projects in our best agricultural lands. Instead a clearly defined zoning and platting process would take its place. We back this 1,000 percent. We all have seen what greed has done to Canyon County; the Coalition feels enough is enough.

The County wants to add policy language to the 2005 Canyon County Comprehensive Plan that would endorse the value of agriculture and recognize the need to preserve agricultural lands. We welcome the idea, but want to see teeth in the ordinances that would do it. Talk is cheap and we can't help but point out that Canyon County has lost well over 25 percent of its harvestable farmland since 1997 because the existing Comprehensive Plan has been largely ignored and the zoning ordinances have been abused in favor of unchecked development.

## Everyone Needs To Get Involved In The Process

The revised comprehensive plan and zoning ordinances are being worked on at the moment and are due to be made public in late November. We are presently working with the Commissioners to make sure our agriculture economy is not sacrificed. But we can sure use your help. Here's how you can be a part of the process:

- ✓ Review the existing Comprehensive Plan and its accompanying zoning ordinances. They are available on the Canyon County website: [www.canyonco.org](http://www.canyonco.org). A copy of the comprehensive plan and zoning ordinances can also be found on the Coalition website: [www.agriculturesfuture.org](http://www.agriculturesfuture.org).
- ✓ Be sure to review the new proposals when they are made public. That is expected to be in late November. There are currently three public workshops planned in the Caldwell, Parma and Melba areas. Attend one or all of the workshops and make your recommendations and comments known. We'll have the time and place of the workshops on our website when they are announced.

Remember. When we say agriculture, we're not just talking an individual farmer on a tractor. We're also talking about food processing companies, seed companies, the milk and cheese industry, wine producers, mint growers, meat packing companies, farm equipment companies, feed companies, irrigation companies, sugar companies, timber companies, the fruit industry, etc. etc. Agriculture provides more than 156,000 jobs in Idaho. It is the stable part of the Idaho economy that off-sets the roller coaster ups and downs of the high tech and manufacturing

industries. And all of that depends completely on one irreplaceable ingredient: farmland.

The Coalition for Agriculture's Future is formed from 30 of the area's largest agri-businesses, financial institutions, ag-related associations and other companies and individuals with agricultural interests in the Treasure





Valley. You can learn more about the Coalition and the issues with which it deals by visiting our web site:

[www.agriculturesfuture.org](http://www.agriculturesfuture.org)